



Station House, Station Approach, West Drayton, UB7

- Station House
- Third floor
- Modern finish
- Available end July
- Luxury bathroom
- Parking
- EPC Rating- D

£1,600 PCM

Description

Cameron Estate Agents are delighted to offer this modern two bedroom third floor apartment located in the heart of West Drayton. Within a stones throw away from the station giving access into London Paddington. Built to a high standard, including granite work tops, down lighting to the kitchen, built in appliances, high ceilings, luxury bathroom with vanity lit mirror and alarm. Parking also included. Presented to the market unfurnished and available end July.

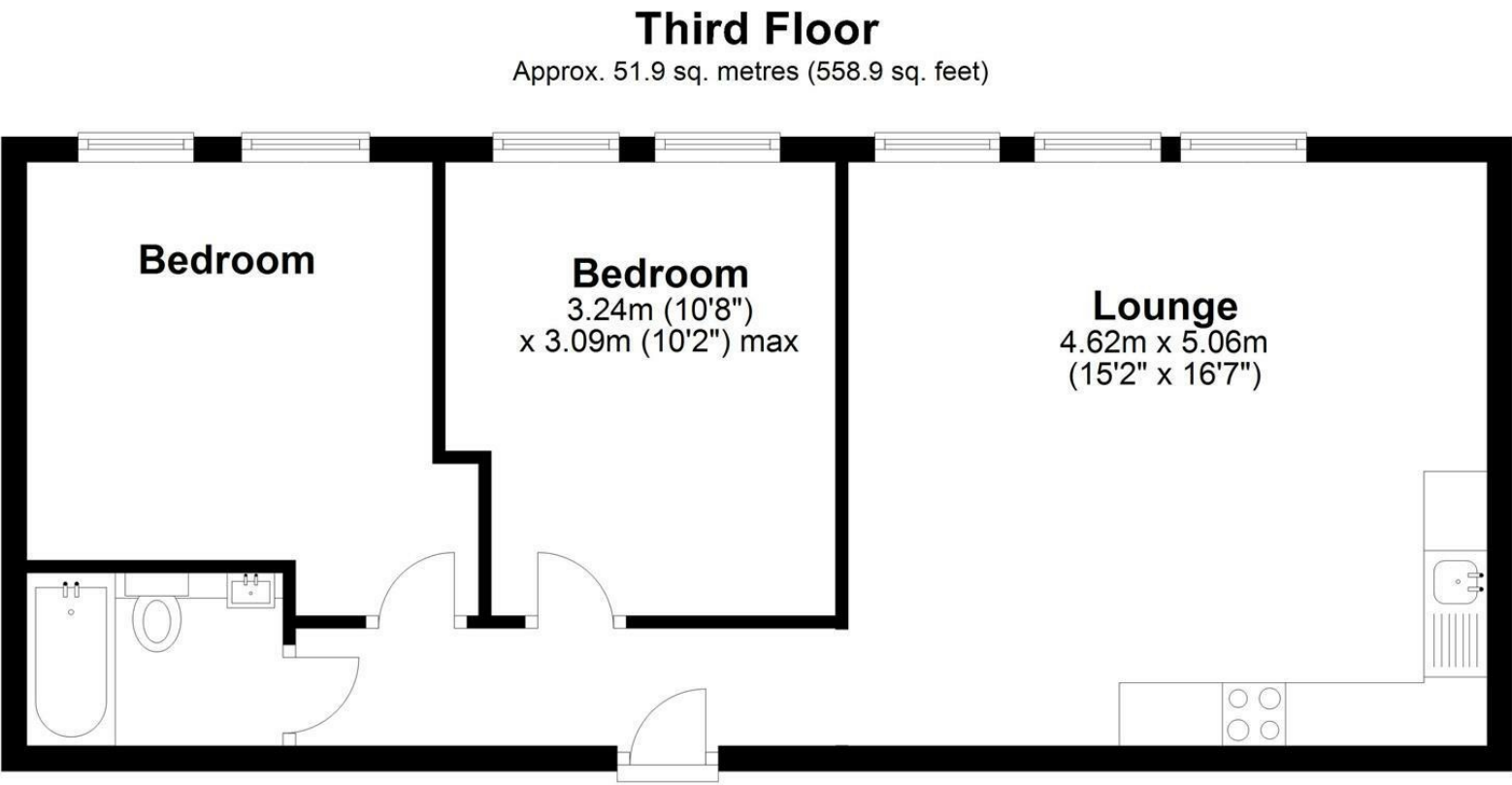

Total area: approx. 51.9 sq. metres (558.9 sq. feet)

IMPORTANT NOTICE

These particulars have been prepared upon information supplied by the Vendor and should be verified by your surveyors and solicitors. We have prepared these sales particulars as a general guide to give a broad description of the property. They are not intended to constitute part of an offer or contract. We have not carried out a structural survey and the services, appliances and specific fittings have not been tested. All photographs, measurements, floor plans and distances referred to are given as a guide only and should not be relied upon for the purchase of carpets or any other fixtures or fittings. Lease details service charge and ground rent (where applicable) are given as a guide only and should be checked and confirmed by your solicitor prior to exchange of contracts